

The Opportunity

The Sidler Company has designed and patented several innovative automotive components. The company has made these patents available for license or sale.

Technology

All of these designs provide:

- Compliance with automotive manufacturing standards
- Minimum of separate parts
- Reduced manufacturing costs
- User convenience.

Detailed engineering drawings are available to facilitate rapid development of a manufacturing program.



Intellectual Property

Patents or published patent applications are available for each of these components, as follows:

US Patent (click to see)	Title (click for one- pager)	Description
6.126.221	Universal Garage Door Opener Mounting Panel	<ul style="list-style-type: none"> • Easy operation of a garage door remote from its convenient compartment • A compartment door that is also the activation button • One-touch operation
5.982.123	Interval Control for Intermittent Wipers	<ul style="list-style-type: none"> • Control of the duration of the interval between successive wipes in response to the quantity of rain. • Sensitivity to vehicle speed without additional sensors • Control system simplification • Hardware reduction
2007/0013202	Pivotable Door for Vehicle Interiors	<ul style="list-style-type: none"> • A convenient easy-to-open door • No binding • Flush exterior
2006/0198155	Panel-Mounted Task Light	<ul style="list-style-type: none"> • A focused lamp mounted in a door • Restricted illumination onto the lap of a passenger • A replacement for <i>overhead</i> reading lights
2006/0113810	Modular Overhead Console Assembly	<ul style="list-style-type: none"> • A movable module within an overhead console • Multiple, interchangeable components • Unique, simple design
2006/0208506	Latching Mechanism Vehicle Panel Door	<ul style="list-style-type: none"> • A desirable "push-push" open and close mechanism • A dampener mechanism for slow opening • A door that stays closed during bumps and collisions • Flush exterior

For More Information

The Company is seeking qualified licensees to bring its innovative automotive component technology into commercial use. For more information, contact:

Dr. Stephen P. Weeks, President
 First Principals, Inc.
 1768 East 25th Street
 Cleveland, OH 44114
 Tel: 216-881-8521
 Fax: 216-881-8522
 email: spweeks@firstprincipals.com
 Website: <http://www.firstprincipals.com>

The Opportunity

The Sidler Company has developed and patented a fundamental design for a Universal Garage Door Opener.

The design provides

- Easy operation of a garage door remote from its convenient compartment
- A compartment door that is also the activation button
- One-touch operation

The design is compliant with all requirements of major automobile manufacturers.

Technology

The Sidler design offers the following advantages:

- Simple operation
- Less expensive than built-in transmitter electronics that mimic the remote
- Originally designed for a major automobile manufacturer

Detailed engineering drawings are available to facilitate rapid development of a manufacturing program.

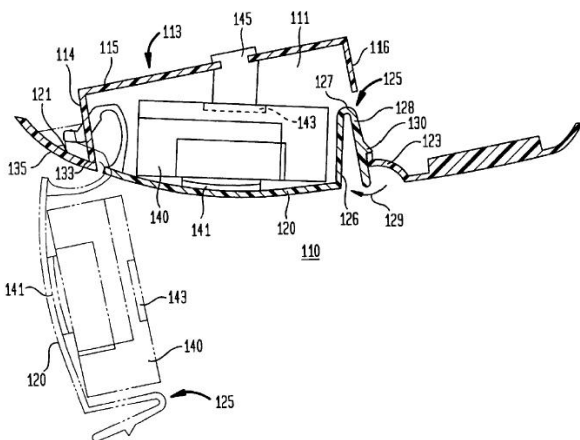

Intellectual Property

The Sidler design is protected by US Patent 6,126,221 "Universal Garage Door Opener Overhead Compartment" and several foreign counterparts.

The patent is highly cited by later patents. It protects the combination of door panel and operating switch.

For More Information

The Company is seeking qualified licensees to bring its innovative garage door opener technology into commercial use. For more information, contact:

Dr. Stephen P. Weeks, President
 First Principals, Inc.
 1768 East 25th Street
 Cleveland, OH 44114
 Tel: 216-881-8521
 Fax: 216-881-8522
 email: spweeks@firstprincipals.com
 Website: <http://www.firstprincipals.com>

The Opportunity

The Sidler Company has developed and patented a simpler, less-expensive control system for intermittent windshield wipers.

The system provides

- Control of the duration of the interval between successive wipes in response to the quantity of rain.
- Sensitivity to vehicle speed without additional sensors
- Control system simplification
- Hardware reduction
- Cost reduction

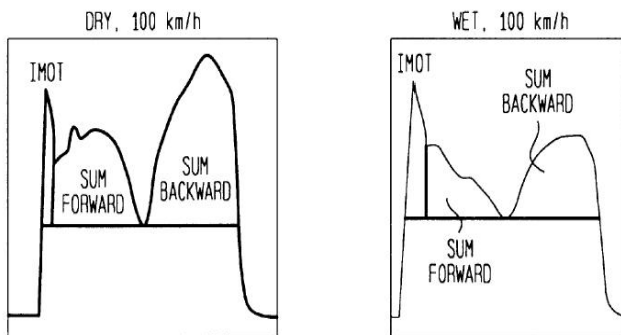

The design is compliant with all requirements of major automobile manufacturers. Detailed engineering drawings are available to facilitate rapid development of a manufacturing program.

Intellectual Property

The Sidler design is protected by US Patent 5,982,123 "Interval control system for intermittent windshield wiper" and several foreign counterparts.

Technology

The Sidler design offers the following advantages:

- Utilizes the current drawn by the windshield wiper to measure wiper-to-windshield friction, indicative of wetness
- Includes a determination of relative air speed in control logic
- Simplifies wiper system
- Eliminates costly rain sensors
- Eliminates air speed sensors
- Eliminates coupling to vehicle speedometer

For More Information

The Company is seeking qualified licensees to bring its innovative wiper control technology into commercial use. For more information, contact:

Dr. Stephen P. Weeks, President
 First Principals, Inc.
 1768 East 25th Street
 Cleveland, OH 44114
 Tel: 216-881-8521
 Fax: 216-881-8522
 email: spweeks@firstprincipals.com
 Website: www.firstprincipals.com

The Opportunity

The Sidler Company has developed and patented an interior storage compartment system with a pivotable door for automobiles.

The system provides

- a convenient easy-to-open door
- no binding
- flush exterior
- decreased component manufacturing complexity and costs

Technology

The Sidler design offers a solution to a heat warping problem wherein panel doors don't align with mating surfaces and/or are difficult to open and close. This is achieved through the use of biasing members that increase stiffness.

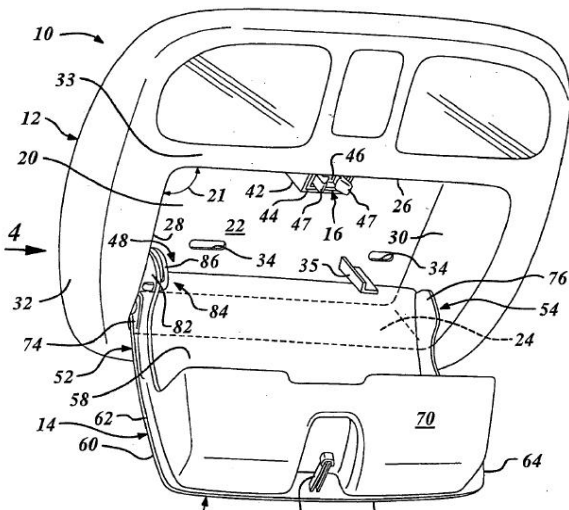
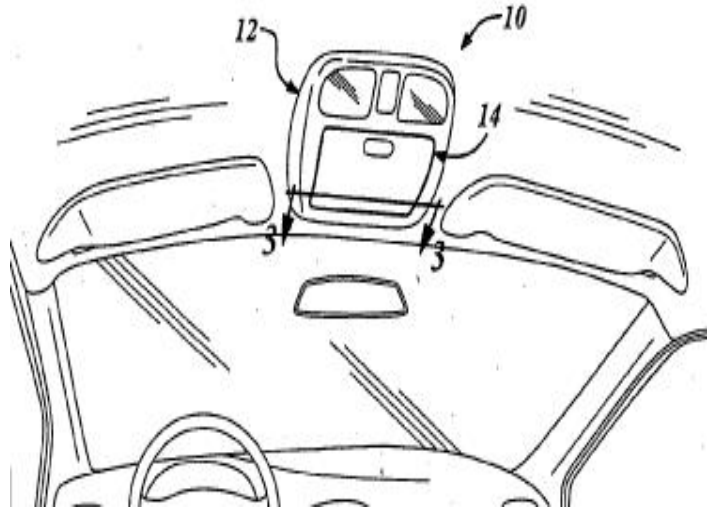

The design is compliant with all requirements of major automobile manufacturers.

Detailed engineering drawings are available to facilitate rapid development of a manufacturing program.

Intellectual Property

The Sidler design is protected by US Patent Application 2007/0013202 "Vehicle interior accessory having a pivotable door" and several foreign counterparts.

For More Information

The Company is seeking qualified licensees to bring its innovative panel door technology into commercial use. For more information, contact:

Dr. Stephen P. Weeks, President
 First Principals, Inc.
 1768 East 25th Street
 Cleveland, OH 44114

Tel: 216-881-8521
 Fax: 216-881-8522
 email: spweeks@firstprincipals.com
 Website: www.firstprincipals.com

PANEL-MOUNTED TASK LIGHT FOR VEHICLE INTERIORS

The Opportunity

The Sidler Company has developed and patented an innovative design for incorporating a recessed task light into a vehicle interior.

The design provides

- a focused lamp mounted in a door or other vehicle interior panel
- restricted illumination onto the lap of a passenger for reading maps and other tasks
- a replacement for *overhead* reading lights which can be distracting to a driver, and potentially unsafe.

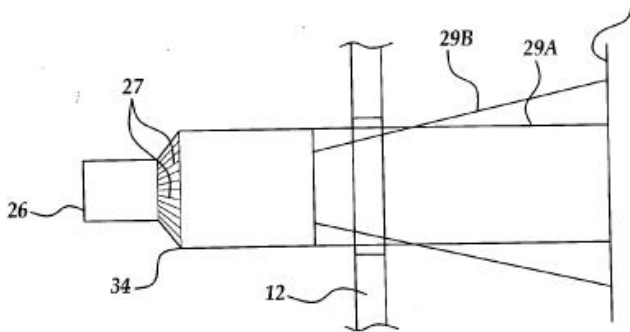
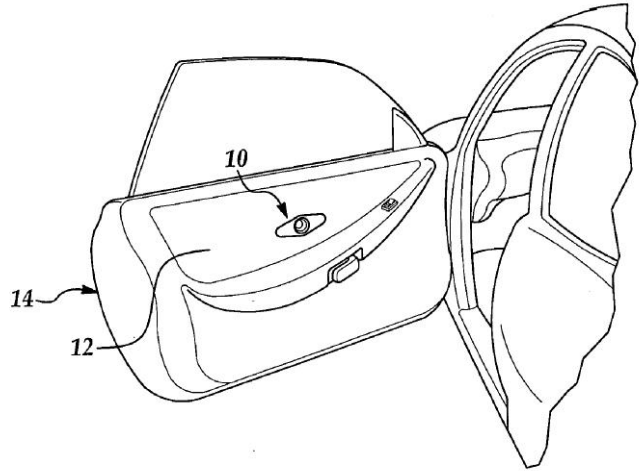

The design is compliant with all requirements of major automobile manufacturers.

Technology

The Sidler design offers the following advantages:

- Reduction of optical flooding and glare
- Low part count
- Optimal packaging
- Robustness
- Low cost

Detailed engineering drawings are available to facilitate rapid development of a manufacturing program.

Intellectual Property

The Sidler design is protected by US Patent Application 2006/0198155 "Panel Mounted Task Light for a Vehicle" and several foreign counterparts.

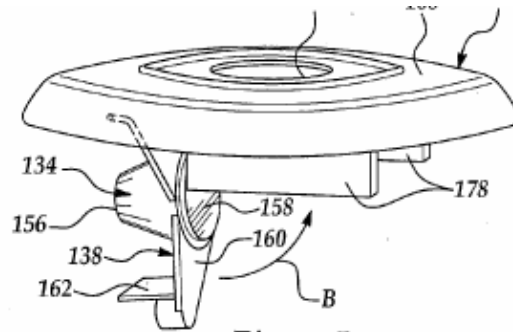

For More Information

The Company is seeking qualified licensees to bring its innovative panel lamp technology into commercial use. For more information, contact:

Dr. Stephen P. Weeks, President
 First Principals, Inc.
 1768 East 25th Street
 Cleveland, OH 44114

Tel: 216-881-8521
 Fax: 216-881-8522
 email: spweeks@firstprincipals.com
 Website: <http://www.firstprincipals.com>

The Opportunity

The Sidler Company has developed and patented a modular overhead console system for automobiles.

The system provides

- a movable module within an overhead console
- multiple, interchangeable components
- unique, simple design
- inexpensive production.

Technology

The Sidler design offers the following advantages:

- includes a rail base and a rail head
- a track defined between the rail head and the rail base
- movable modules that slidably mount to the rail

Component modules can be assembled in whatever order the owner desires.

The design is compliant with all requirements of major automobile manufacturers.



Intellectual Property

The Sidler design is protected by US Patent Application 2006/0113810 “Modular overhead console assembly for a vehicle” and several foreign counterparts.

For More Information

The Company is seeking qualified licensees to bring its innovative overhead console technology into commercial use. For more information, contact:

Dr. Stephen P. Weeks, President
 First Principals, Inc.
 1768 East 25th Street
 Cleveland, OH 44114
 Tel: 216-881-8521
 Fax: 216-881-8522
 email: spweeks@firstprincipals.com
 Website: www.firstprincipals.com

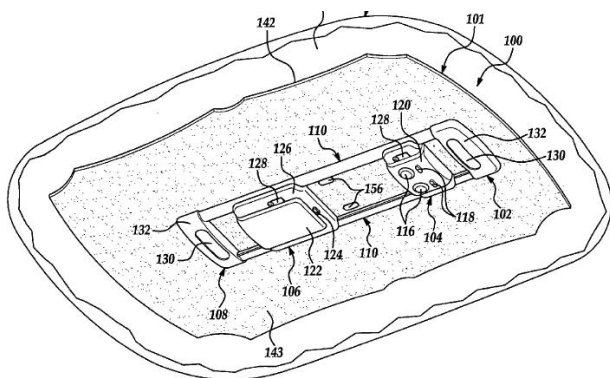

Detailed engineering drawings are available to facilitate rapid development of a manufacturing program.

LATCHING MECHANISM FOR VEHICLE PANEL DOORS

The Opportunity

The Sidler Company has developed and patented unique panel door latching mechanism for automobiles.

The system provides

- a desirable “push-push” open and close mechanism
- a dampener mechanism for slow opening
- a door that stays closed during bumps and collisions
- flush exterior
- decreased component manufacturing complexity and costs

Technology

The Sidler design offers a vehicle interior latch that is fully optimized for simplicity, packaging, safety, flexibility, and robustness.

The design of the latch prevents the panel door from bouncing open on collision or from accidental pushing of the door panel. This is controlled by the dampener mechanism that also regulates the speed with which the door opens.

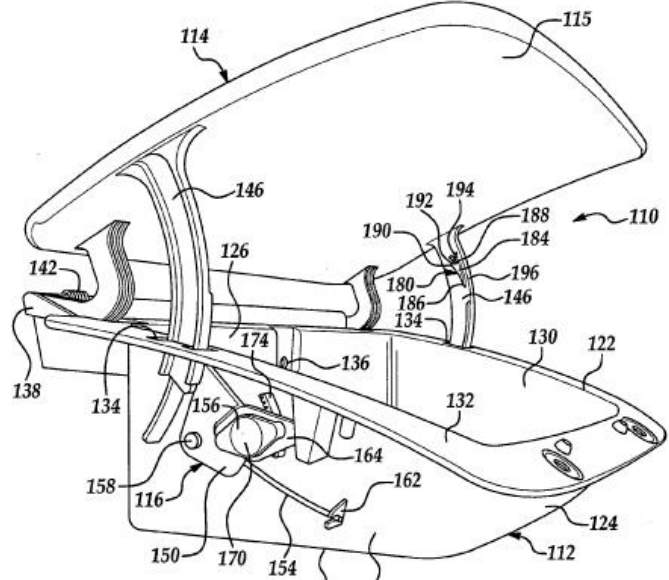

Intellectual Property

The Sidler design is protected by US Patent Application 2006/0208506 “Latching mechanism” and several foreign counterparts.

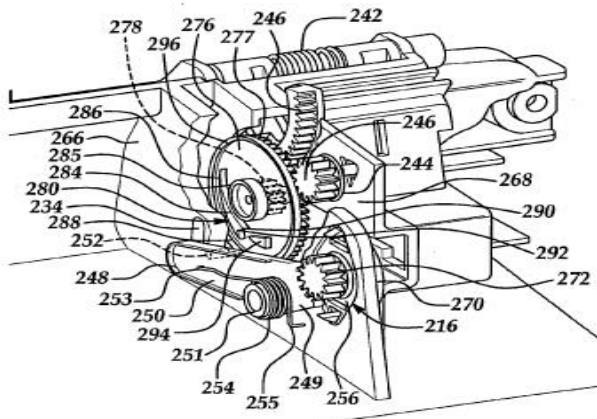

The design is compliant with all requirements of major automobile manufacturers.

Detailed engineering drawings are available to facilitate rapid development of a manufacturing program.

For More Information

The Company is seeking qualified licensees to bring its innovative panel door latching technology into commercial use. For more information, contact:

Dr. Stephen P. Weeks, President
 First Principals, Inc.
 1768 East 25th Street
 Cleveland, OH 44114

Tel: 216-881-8521

Fax: 216-881-8522

email: spweeks@firstprincipals.com

Website: www.firstprincipals.com