

LATCHING MECHANISM FOR VEHICLE PANEL DOORS

The Opportunity

Sidler, Inc. has developed and patented unique panel door latching mechanism for automobiles.

The system provides

- a desirable “push-push” open and close mechanism
- a dampener mechanism for slow opening
- a door that stays closed during bumps and collisions
- flush exterior
- decreased component manufacturing complexity and costs

Technology

The Sidler design offers a vehicle interior latch that is fully optimized for simplicity, packaging, safety, flexibility, and robustness.

The design of the latch prevents the panel door from bouncing open on collision or from accidental pushing of the door panel. This is controlled by the dampener mechanism that also regulates the speed with which the door opens.

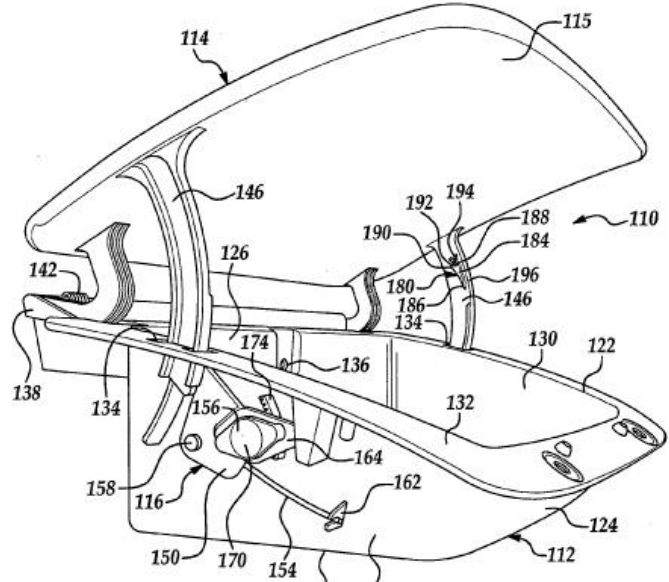

Intellectual Property

The Sidler design is protected by US Patent Application 2006/0208506 “Latching mechanism” and several foreign counterparts.

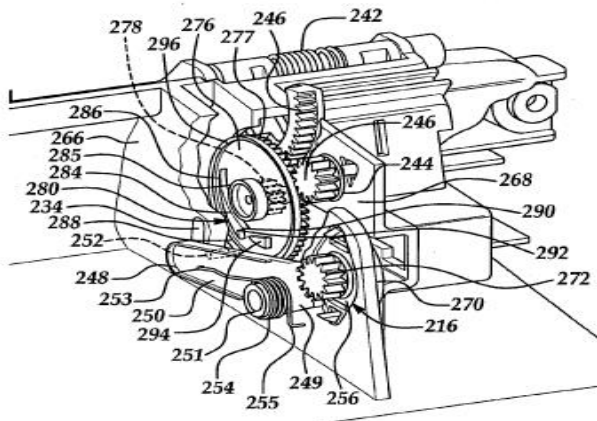

The design is compliant with all requirements of major automobile manufacturers.

Detailed engineering drawings are available to facilitate rapid development of a manufacturing program.

For More Information

The Liquidating Trustee is seeking qualified bidders to acquire this intellectual property. For more information, contact:

Dr. Stephen P. Weeks, President
 First Principals, Inc.
 1768 East 25th Street
 Cleveland, OH 44114

Tel: 216-881-8521
 Cell: 216-533-6371
 Fax: 216-881-8522

email: spweeks@firstprincipals.com
 Website: www.firstprincipals.com